

Birlea

Suppliers of inspiration

Assembly Instructions

*Thank you for
purchasing a
Birlea product.*

For a chance to win a *Love 2 Shop* voucher simply post a picture of your new product on your preferred social channels tagging Birlea Furniture and using the hashtag **#ShareYourStyle** and **#Birlea**. One winner will be selected at random each month.

To view our full terms and conditions please visit our website. www.birlea.com

Are you happy with your purchase?

Yes: That's great, we would love to hear more from you. Please leave us a review on our social media channels or Trustpilot. Your feedback will be greatly appreciated.

No: If for any reason there is something missing, indifferent or incorrect with your order, please contact the retailer you purchased the item from. We will work with the retailer to resolve your issue as quickly as possible.



www.birlea.com

ASSEMBLY INSTRUCTIONS **URBAN 1 DRAWER COFFEE TABLE**

IMPORTANT : READ THESE INSTRUCTIONS CAREFULLY BEFORE ATTEMPTING TO ASSEMBLE OR USE YOUR URBAN 1 DRAWER COFFEE TABLE.

PLEASE KEEP THESE INSTRUCTIONS FOR FUTURE REFERENCE.

ASSEMBLY:

Assembly should be carried out with this item laying flat, not standing upright.

Assemble on a soft, clean surface to prevent damages.

To erase the numbers printed on the pieces, use the rubber into the accessories pack.

HEALTH & SAFETY:

DO NOT use this product if any parts are missing, damaged or worn.

DO NOT use this product unless all fixings are secured.

Always use on a level, even surface.

CARE & MAINTENANCE:

Periodically check all screws & fixings to ensure they are secure.

DO NOT push this product as this will cause damage.

Always lift this product with two people to repositions.

Keep any sharp objects away from this product .

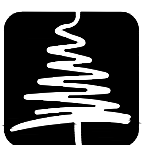
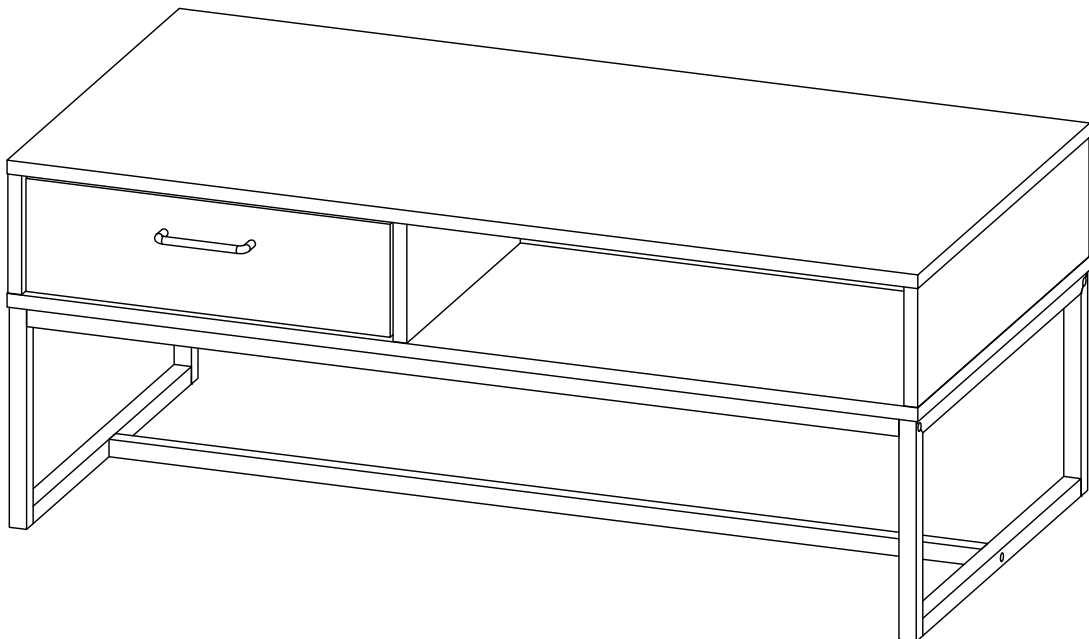

Birlea

Suppliers of inspiration

www.birlea.com

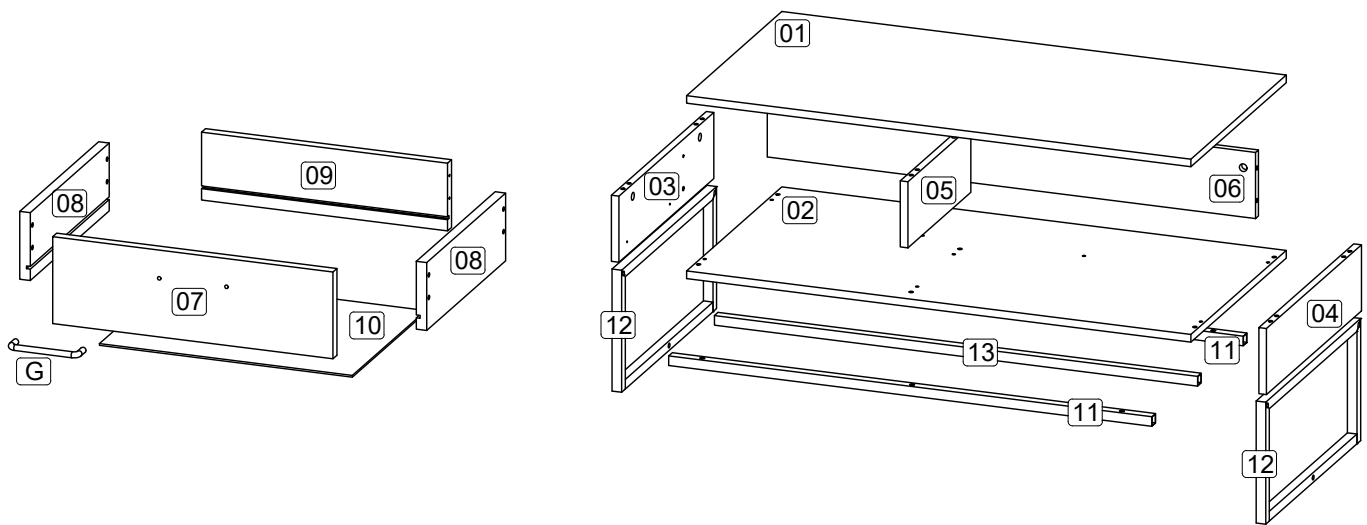

Parts List			Hardware List		
Part	Description	Qty	Part	Description	Qty
01	Top panel	1	A1	Cam lock 	10
02	Bottom panel	1	A2	Minifix screw 	10
03	Side panel (Left)	1	A3	Plastic cap 	10
04	Side panel (Right)	1	B	M8 x 30mm Wood Dowel 	14
05	Center panel	1	C	M6 x 50mm CSK Cap Wood screw 	8
06	Middle panel	1	D	M3.5 x 16mm C.B Screw 	12
07	Drawer front	1	E	M4 x 38mm C.B Screw 	8
08	Drawer side	2	F	Allen key M4 	1
09	Drawer back	1	G	Handle 100.96. BLM 	1
10	Drawer bottom	1	H	Handle screw M4 x 19mm 	2
11	Metal top	2	I	JCBC screw M6 x 30mm 	6
12	Metal Side (Left & Right)	2	J	JCBC screw M6 x 40mm 	6
13	Metal middle	1	K1	12" Drawer slide (Left / Right) 	2
			K2	12" Drawer slide (Left / Right) 	2

**** You will need a small mallet and a screwdriver for assembly.**

**** Some screws and wooden dowel may remain.**

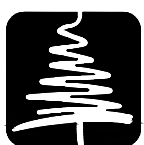

Step 1: Prepare these parts for assembly using hardware parts A1, A2, B, D and K1.

DO NOT use any power tools as this may damage the frame and will invalidate any claim.

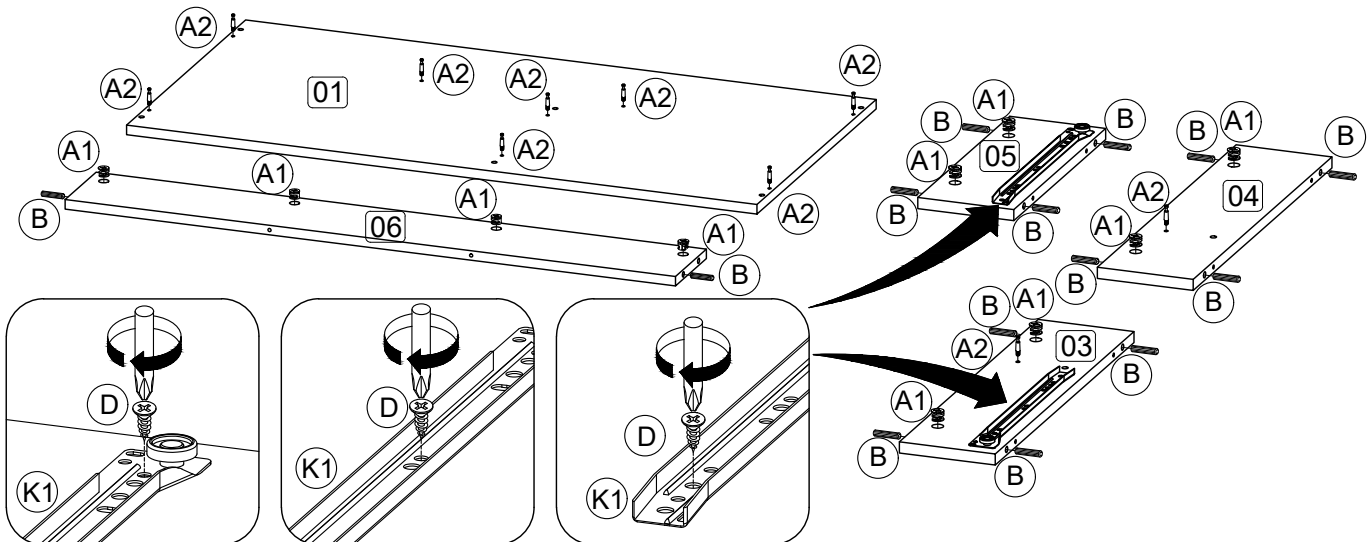

Step 2: Attach the panel (5) and (6) to panel (1) using hardware A1 and A3 with a screwdriver (not provided).

DO NOT use any power tools as this may damage the frame and will invalidate any claim.

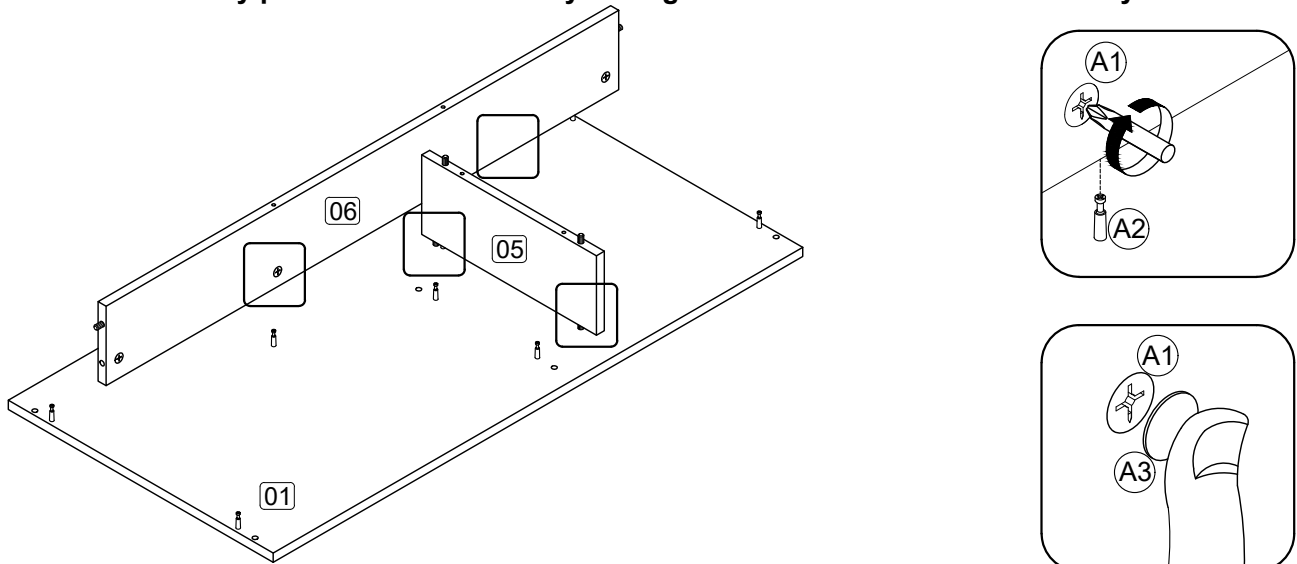

Step 3: Attach the panel (3) and (4) to panel (1) and (6) using hardware A1 and A3 with a screwdriver (not provided).

DO NOT use any power tools as this may damage the frame and will invalidate any claim.

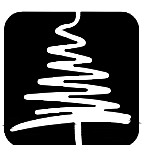
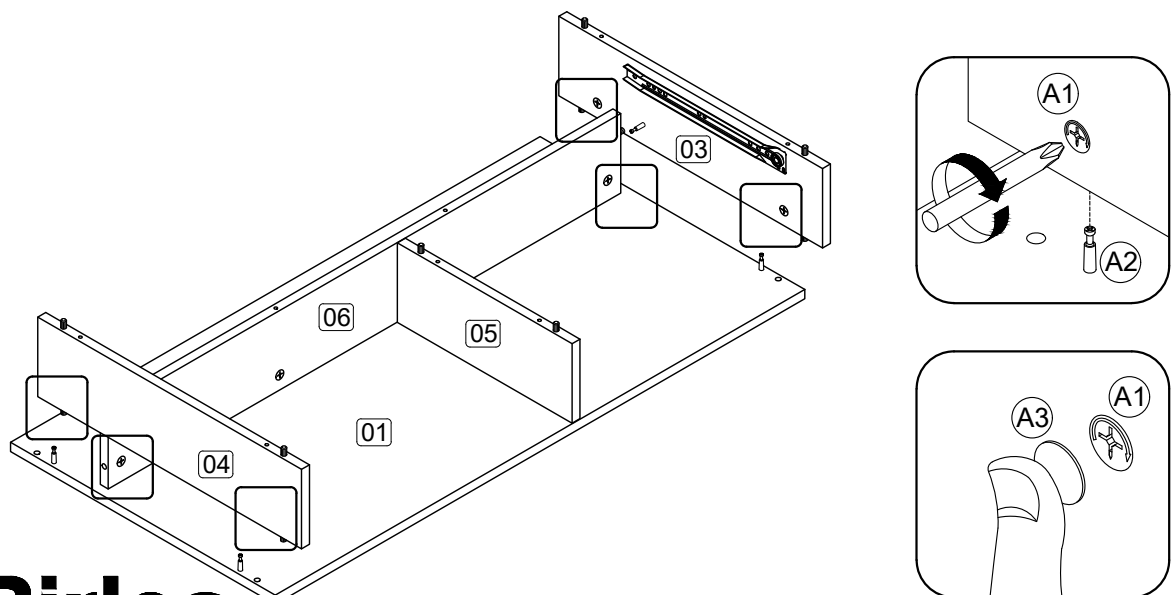

Birlea
Suppliers of inspiration

Step 4: Attach the panel (2) to panel (3), (4), (5) and (6) using hardware C and F.

DO NOT use any power tools as this may damage the frame and will invalidate any claim.

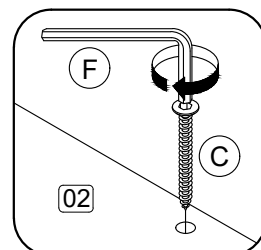
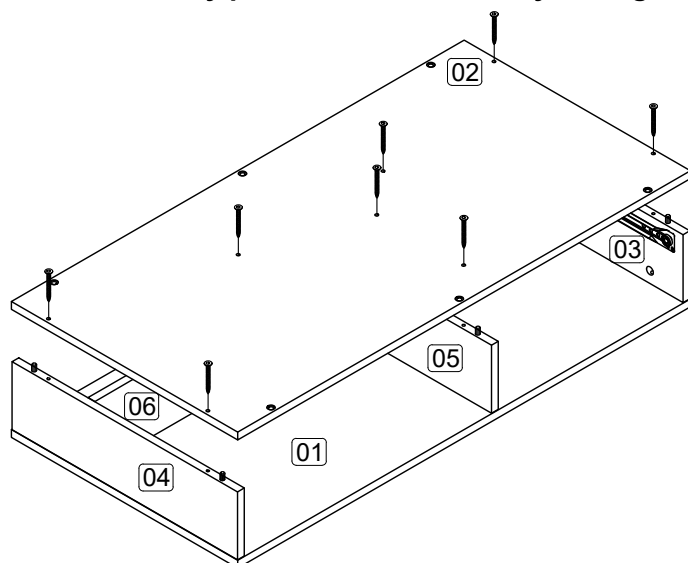

Step 5: Attach the Metal Top (11) to panel (2) using hardware I and F.

DO NOT use any power tools as this may damage the frame and will invalidate any claim.

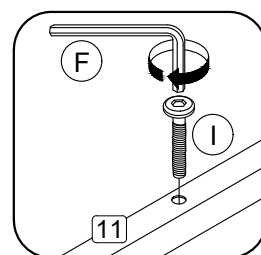
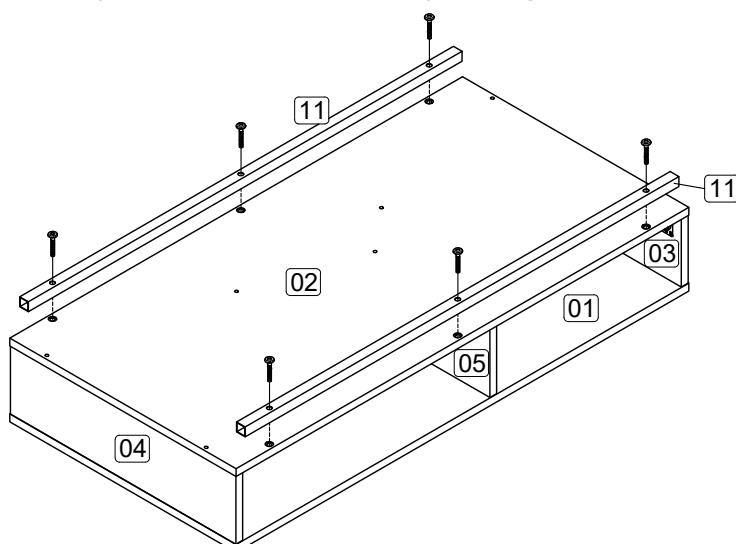

Step 6: Attach the Metal Side (12) to Metal Middle (13) using hardware J and F.

Attach the Metal Side (12) to Metal Top (11) using hardware J and F.

DO NOT use any power tools as this may damage the frame and will invalidate any claim.

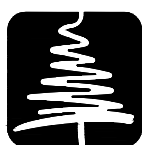
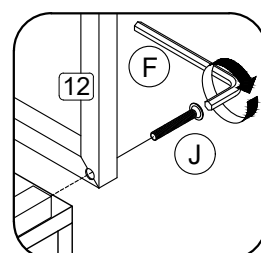
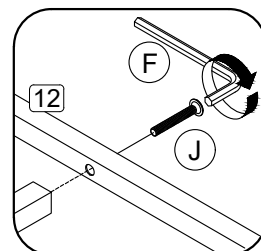
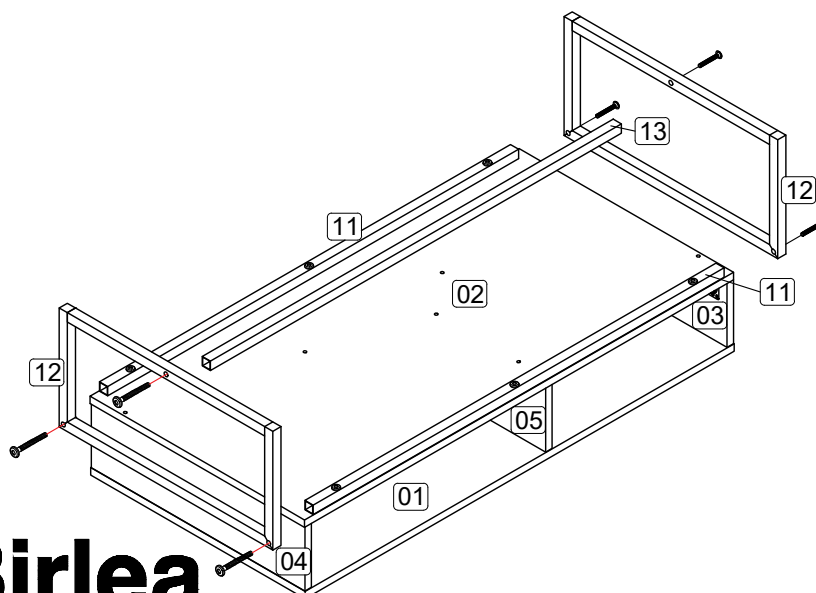

Birlea
Suppliers of inspiration

Step 7: Fix hardware G onto panel (7) using hardware H with a screwdriver (not provided).

DO NOT use any power tools as this may damage the frame and will invalidate any claim.

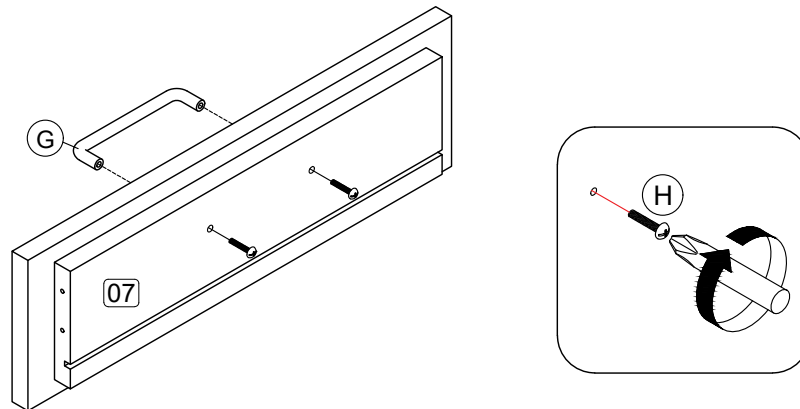

Step 8: Assemble the drawer components using hardware D, E and K2.

In this step only show one of the drawers.

DO NOT use any power tools as this may damage the frame and will invalidate any claim.

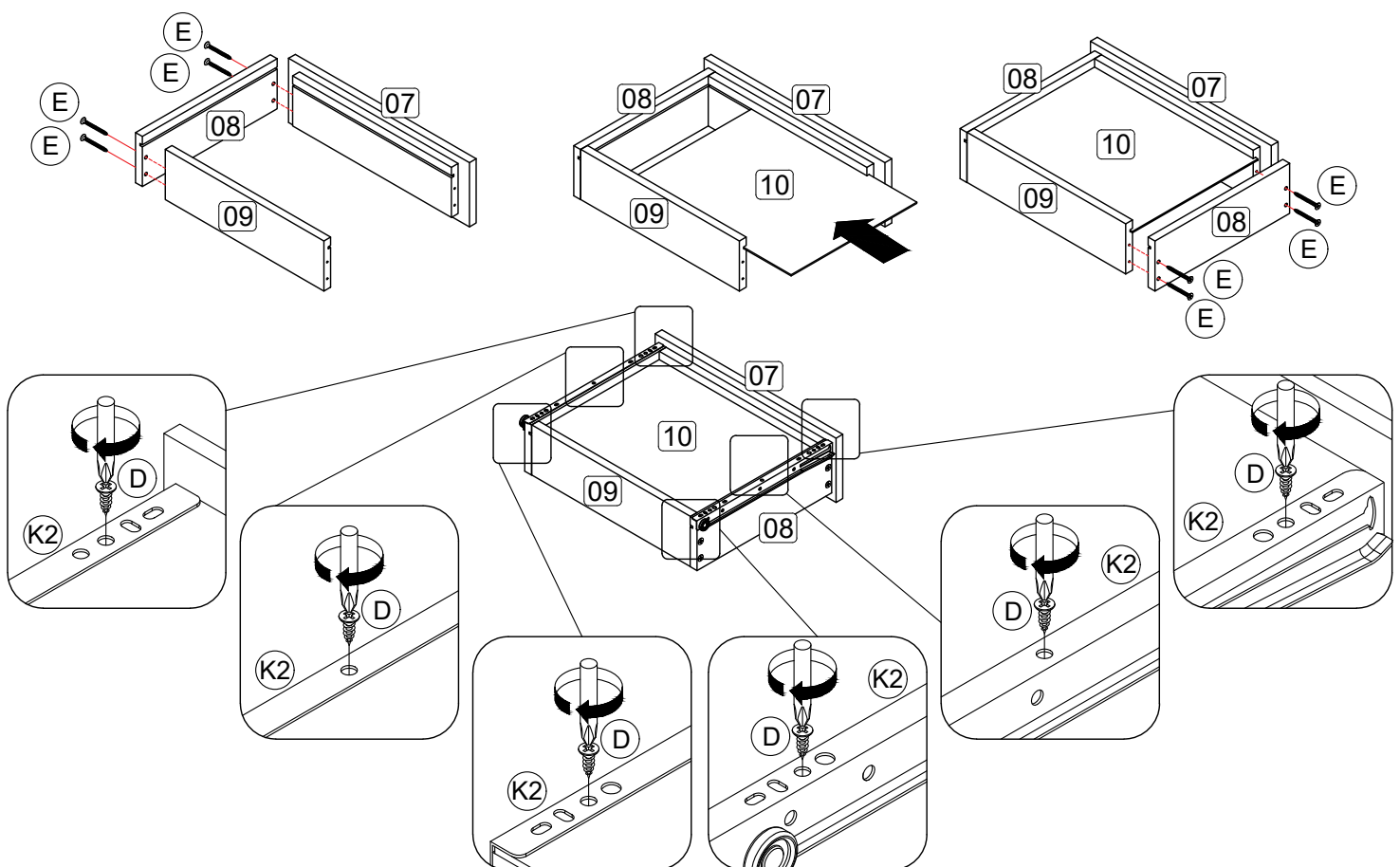

Birlea
Suppliers of inspiration

Step 9: Assemble the drawers in place along the drawer slides.

DO NOT use any power tools as this may damage the frame and will invalidate any claim.

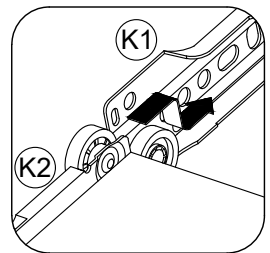
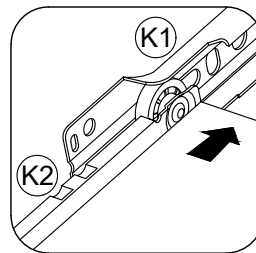
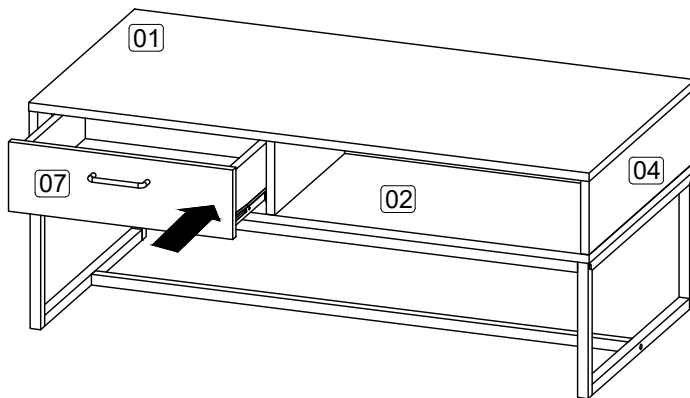

Additional Information:

- For complete product information, images and dimension diagrams please visit the website www.birlea.com
- If you have any issues with your item please contact the retailer directly you purchased it from who will be able to resolve any issues with Birlea.
- Why don't you send us photos of your assembled furniture to info@birlea.com to be shared in our #birleahome feature on instagram.

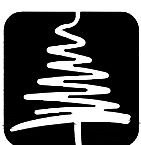

Birlea

Suppliers of inspiration